



ACCUMAX
GLOBAL

Gas Detection

EDITION 1



Contents

| | |
|--|-----------|
| Portable Gas Detectors | 3 |
| Portable Gas Detector AM-XP-300011 Series | 3 |
| Gas Leak Detector AM-XP-702IIIS | 5 |
| Digital Oxygen Indicator AM-XO-326IIs. | 6 |
| Multi-Gas Indicator AM-XA-4000II | 7 |
| O ₂ /H ₂ S Indicator AM-XOS-326 | 8 |
| Personal CO/O ₂ /H ₂ S Monitor AM-XX-2200. | 8 |
| Semiconductor Gas Detector AM-XPS-711. | 9 |
| Gas Leak Detector AM-XP-704III | 9 |
| Gas Leak Detector AM-XP-703DIII. | 10 |
| Steel Dust Metre AM-SDM-72/AM-SDM-73. | 10 |
| Others | 11 |
| Odour Level Indicator AM-XP-329m | 11 |
| Odour Level Indicator AM-XP-329IIIR. | 11 |
| Real-Time VOC Monitor AM-XP-3320II-V | 12 |
| VOC Monitor AM-XV-389 | 12 |
| Gas Detector Heads | 13 |
| Diffusion Type Gas Detector Head with Display AM-KD-12 Series | 13 |
| Suction Type Gas Detector Head with Display AM-PD-12 Series | 15 |
| Semiconductor Gas Detector AM-PS-8 Series | 16 |
| Odour (Environment) Detector AM-COD-203 | 18 |
| Semiconductor Gas Detector AM-PS-7/AM-PS-7-M | 18 |
| Suction Type Gas Detector Head AM-PD-14A/AM-PD-14B | 19 |
| Suction Type Gas Detector Head AM-PE-2CC/AM-PE-2DC. | 19 |
| Diffusion Type Gas Detector Head AM-KD-5A/AM-KD-5B | 20 |
| Diffusion Type Gas Detector Head AM-KS-2D-N/AM-KS-20-N. | 20 |
| Suction Type Gas Detector Head AM-PS-2DP-N/AM-PS-2DE-Ex. | 21 |
| Suction Type Gas Detector Head AM-PS-20P-N/AM-PS-20E-Ex. | 21 |
| Panel Mount Unit AM-VAS/AM-V3 Series | 22 |
| Indicator Panel AM-UV-810 | 23 |
| Single Point Gas Alarm System AM-NV-120 Series | 24 |
| Multi-Point Gas Alarm System AM-NV Series | 25 |
| Simplified Gas Alarm System AM-B-780/AM-KD-5 | 26 |
| Single Point Gas Detector with Indicator and Alarm AM-KS-7 Series. | 27 |

Portable Gas Detectors

AM-XP-300011 Series Portable Gas Detector

PRODUCT FEATURES

- » Convert to 32 different types of gas.
 - *Only for AM-XP-3310II, AM-XP-331811, AM-XP-3360II-W and AM-XP-3368II-W units, in which GAS1 (target gas) is set to methane, isobutane or propane.
 - *Converted gas concentration is only an estimate and not guaranteed.
- » Waterproof IP67
- » Measures in "%LEL" and "ppm".
(for AM-XP-336011-W and AM-XP-336811-W)

Specifications

| | |
|------------------------------------|--|
| Sampling Method | Internal pump |
| Power Source | 4 x AA Alkaline batteries, Approx. 15 hours. Rechargeable nickel metal hydride batteries, Approx. 15 hours |
| Operating Temperature and Humidity | -20 to +50°C 95 %RH. No condensation |
| Certifications | ATEX: Ex IIIG Ex ia da IIC T4 Ga ¹ , ECEX: Ex ia da IIC T4 Ga ¹ , CE (ATEX, EMC, RoHS, RE and LVD directives), UL: Class 1, Division 1, Groups A, B, C and D, Class 1, Zone O AEx da ia I IC Ga (Other than XP-3380II) |
| IP Rating | IP67 |
| Dimensions | 91 x 164 x 44mm |
| Weight | Approx. 460 g |
| Accessories | Gas sampling tube (1 m), Shoulder strap, Drain filter, Filter element, 4 x AA Alkaline batteries (or 4 x Rechargeable nickel metal hydride AA batteries), 3 x Screen protector films |

CONVERTIBLE GAS LIST

| | | |
|----------------|-------------------|----------|
| Acetone | n-Hexane | Methanol |
| Toluene | Ethylbenzene | Hydrogen |
| Propyl acetate | DME | Ethylene |
| MIBK | n-Butane | Ethane |
| MEK | p-Xylene | |
| Cyclohexane | THF | |
| Acetylene | Propane | |
| o-Xylene | Methylcyclohexane | |
| Propylene | IPA | |
| n-Pentane | Gasoline | |
| Ethyl acetate | Ethanol | |
| Cyclopentane | n -Heptane | |
| Benzene | Methane | |
| m-Xylene | i-Butane | |

AM-XP-3000II



| Model | Multi Gas Detector | | | | | |
|--------------------|--|----------------------------|---|----------------------------|---------------------------------|----------------------------|
| | AM-XP-3368II-W | | AM-XP-3368II | | AM-XP-3318II | |
| Target Gas | Combustible Gas / Solvent Vapor | Oxygen | Combustible Gas / Solvent Vapor | Oxygen | Combustible Gas / Solvent Vapor | Oxygen |
| Sensor Type | Catalytic | Galvanic Cell | Catalytic | Galvanic Cell | Catalytic | Galvanic Cell |
| Measuring Range | 0.0-100.0% LEL (100.1-110.0% LEL) Enable to display in ppm | 0-25 vol% (25.1-50.0 vol%) | 0-5000 ppm or 0-10000 ppm (5001-550 ppm or 10001-11000 ppm) | 0-25 vol% (25.1-50.0 vol%) | 0-100% LEL (100.1-110.0% LEL) | 0-25 vol% (25.1-50.0 vol%) |
| Display Resolution | 0.1 % LEL or 1 ppm | 0.1 vol% | 1 ppm | 0.1 vol% | 0.1 %LEL | 0.1 vol% |
| Alarm Set Value | 20 %LEL | 18 vol% | 250 ppm or 500 ppm | 18 vol% | 20% LEL | 18 vol% |
| Response Time | T90: 30 sec. | — | T90: 30 sec. | — | T90: 30 sec. | — |

| Model | Comustible Gas Detector | | | Oxygen Detector | |
|--------------------|--|---|-------------------------------|-----------------------------|--------------------------------|
| | AM-XP-3368II-W | AM-XP-3368II | AM-XP-3310II | AM-XP-3340II | AM-XP-3380II (-E) ² |
| Target Gas | Combustible Gas / Solvent Vapor | | | Combustible gas / Inert gas | Oxygen |
| Sensor Type | Catalytic | | | Thermal conductivity | Galvanic cell |
| Measuring Range | 0.0-100.0% LEL (100.1-110.0% LEL) Enable to display in ppm | 0-5000 ppm or 0-10000 ppm (5001-550 ppm or 10001-11000 ppm) | 0-100% LEL (100.1-110.0% LEL) | 0-100 vol% | 0-100 vol% (25.1-50.0 vol%) |
| Display Resolution | 0.1 % LEL or 1 ppm | 1 ppm | 0.1 % LEL | 0.1 vol% | 0.1 vol% |
| Alarm Set Value | 20 %LEL | 250 ppm or 500 ppm | 20% LEL | 50 vol% | 18 vol% |
| Response Time | T90: 30 seconds | | | T90: 60 seconds | — |



AM-702IIIS Gas Leak Detector

PRODUCT FEATURES

- » Trace gas detectable with high sensitivity sensor
- » Automatic zero adjustment and stop pump functionality
- » Detects combustibile and refrigerant gases

TARGET GAS

- » Refrigerant: R22, R32, R404A, R407C, R600a (i-B), R410A, etc.
- » Combustible Gas: Methane, i-butane, Hydrogen, Ammonia, Propane, Benzene, Acetylene, EO, Ethylene, Ethane, Butadiene, etc.



AM-XP-702IIIS

| Model | AM-XP-702IIIS-A | AM-XP-702IIIS-B | AM-XP-702IIIS-F |
|------------------------------------|---|----------------------|------------------------------------|
| Target Gas | 2 combustibile gases | 1 combustibile gases | Refrigerant and 1 combustibile gas |
| Sensor Type | Hot-wire semiconductor | | |
| Sampling Method | Internal Pump | | |
| Detectable Leak Rate | Methane, LPG, 3.3×10^{-6} Pa.m ³ /s | | R-407C 12.4 g/y, R-410A 11.2 g/y |
| Detectable Concentration | 10 ppm | | 30 ppm |
| Response Time | ≤5 sec. except Refrigerant | | |
| Power Source | 2 x AA Alkaline batteries, Approximately 12 hours | | |
| Operating Temperature and Humidity | -2D°C-50°C, 30 to 85 %RH | | |
| Certifications | UL: Class 1, Division 1, Groups C and D, T3 Class 1, Zone 0, AEx ia IIB T3 Ga Japan Ex: Ex ia II B T3 Ga | | |
| Dimensions | 38 x 135 x 32mm | | |
| Weight | Approx.190 g | | |
| Accessories | Soft case, Drain filter, Filter element, Gas prove, Dust filter, 2xAA Alkaline batteries | | |
| Options | Annealed copper tube, Gas collector, etc. | | |

AM-XO-326IIs Digital Oxygen Indicator

PRODUCT FEATURES

- » Monitor continuously for up to 15,000 hours
- » With 2 x AA Alkaline batteries
- » Automatic zero adjustment
- » Detects oxygen from a distance with detached sensor



| Model | AM-XO-326IIIsA | AM-XO-326IIIsB | AM-XO-326IIIsC |
|------------------------------------|--|--------------------|--------------------|
| Cable Length | 5m | 1m (spiral cable) | 10 m |
| Target gas | Oxygen | | |
| Sensor Type | Galvanic cell | | |
| Detection Range | 0 to 25.0vol% (25.1 to 40.0 vol%) | | |
| Display Resolution | 0.1 vol% | | |
| Alarm Set Value | 1st: 19.5 vol%, 2nd: 18.0 vol% | | |
| Response Time | 20 seconds | | |
| Power Source | 2x AA Alkaline batteries, Approximately 15,000 hours | | |
| Certifications | Ex ia T3 Ga (Japan Ex) | | |
| Operating Temperature and Humidity | -10 to +40°C 301085 %RH | | |
| Dimensions | 66 x 170 x 29mm | 66 x 120 x 29mm | 66 x 200 x 29mm |
| Weight | Approximately 340g | Approximately 256g | Approximately 410g |

AM-XA-4000II Multi-Gas Detector



AM-XA-4000II

PRODUCT FEATURES

- » 40 hours or more of continuous operation with a single AAA battery (when used in long-life mode)
- » Expected Sensor life of 3 years
- » 2 battery types (alkaline battery unit or rechargeable battery unit)

| Model | AM-XA-4000II | | | |
|--|--|------------------------------------|--|---|
| Target gas | Combustive Gas (Methane or Isobutane) | Oxygen | Hydrogen Sulfide | Carbon Monoxide |
| Sensor Type | Catalytic | Galvanic cell | Electrochemical | Electrochemical |
| Detection Range (Reference Indication) | 0 to 100%LEL (101 to 110 %LEL) | 0 to 25.0 vol% (25.1 to 50.0 vol%) | 0 to 30.0 ppm (30.1 to 50.0 ppm) | 0 to 300 ppm (301 to 2000 ppm) |
| Display Resolution | 1 %LEL | 0.1 vol% | 0-35 ppm: 0.1 ppm 35-150 ppm: 0.5 ppm | 0-350 ppm: 1 ppm 350-2000 ppm: 5 ppm |
| Alarm Set Value | 1st | 10 %LEL | 19.5 vol%LEL | 10.0 ppm |
| | 2nd | 30 %LEL | 18.0 vol%LEL | 15.0 ppm |
| Operating Temperature and Humidity | -20 to +50°C, 30 to 85 %RH (non condensing) | | | |
| Power Source | 1x AAA alkaline battery, Approx. 40 hours (long-life mode), Rechargeable nickel metal hydride AA battery, Approximately 40 hours (long-life mode) | | | |
| Certifications | Ex ia IIC T3 Gd (Japan Ex), II 1 G Ex ia IIC T3 Ga (ATEX), Class 1 Zone 0 AEx ia IIC T3 Ga (UL) | | | |
| IP Rating | IP67 | | | |
| Dimensions | 70 x 72 x 26mm | | | |
| Weight | Approximately 130g | | | |
| Accessories | Safety-Pin band, 1 x AAA Alkaline battery, 2 x Filter elements | | | |
| Options | Pump unit, Alligator clip, Datalogger kit, Leather case, Belt clip | | | |



AM-XOS-326 O₂/H₂S Indicator

PRODUCT FEATURES

- » Detects oxygen and hydrogen sulfide from a distance
- » Waterproof sensor
- » 3 alarm types: buzzer, alarm lamp, flashing LCD



AM-XOS-326

| Model | | AM-XOS-326 | |
|--|-----|--|------------------------------------|
| Target gas | | Oxygen | Hydrogen sulfide |
| Sensor Type | | Galvanic cell | Electrochemical |
| Detection Range (Reference Indication) | | 0 to 25.0 vol% (25.1 to 50.0 vol%) | 0.0 to 30.0 ppm (30.5 to 50.0 ppm) |
| Display Resolution | | 0.1 vol% | 0.5 ppm |
| Alarm Set Value | 1st | 19.5 vol% | 10.0 ppm |
| | 2nd | 18.0 vol% | 15.0 ppm |
| Response Time | | ≤20s seconds (90%) | ≤30s seconds (90%) |
| Operating Temperature | | -10 to 40°C | |
| Power Source | | 2x AA alkaline batteries, Approximately 50 hours | |
| Dimensions | | Main Unit: 66 x 195 x 29mm Sensor part: 44 x 75mm Sensor cable: 5m | |
| Weight | | Approximately 450g | |
| Accessories | | Soft case, Sholder strap, 2x AA Alkaline batteries, 2x Filter element | |

AM-XX-2200 Personal CO/O₂/H₂S Monitor

PRODUCT FEATURES

- » 5,000 hours of continuous operation
- » 3 alarm types: loud buzzer, alarm lamp and vibration
- » Available with TWA (Time Weighted Average) concentration display



AM-XX-2200

| Model | | AM-XX-2200 | | |
|--|-----|---|------------------------------|---------------------------------|
| | | AM-XX-2200 | | |
| Target gas | | Carbon Monoxide | Oxygen | Hydrogen Sulfide |
| Sensor Type | | Catalytic | Galvanic cell | Electrochemical |
| Detection Range (Reference Indication) | | 0 to 300 ppm (300 to 2000 ppm) | 0 to 25 vol% (25 to 50 vol%) | 0 to 30.0 ppm (30.1 to 100 ppm) |
| Display Resolution | | 1 ppm | 0.1 vol% | 0.1 ppm |
| Alarm Set Value | 1st | 50 ppm | 19.5 vol% | 0.1 ppm |
| | 2nd | 150 ppm | 18.0 vol% | 15.0 ppm |
| Response Time | | 30 seconds | 20 seconds | 30 seconds |
| Certifications | | Ex ib IIB T3 gb (Japan EX), CE | | |
| Operating Temperature and Humidity | | -10 to +40°C, 30 to 90 %RH | | |
| Power Source | | 1x MA Alkaline battery, Approximately 5,000 hours | | |
| Dimensions | | 65 x 64 x 22mm | | |
| Weight | | Approximately 75g | | |
| Accessories | | 1x MA Alkaline battery, 1x Safety pin adaptor | | |
| Options | | Leather case, Heat resistant leather case, Simple inspection jig, Helmet clip, etc. | | |

AM-XPS-711 Semiconductor Gas Detector

PRODUCT FEATURES

- » World's smallest portable NF3 detector
- » Detect various toxic gases using simple 'plug-and-play' sensors
- » No need to calibrate before each use



AM-XPS-711

| Model | AM-XPS-711 |
|------------------------------------|---|
| Target gas | Semiconductor gases |
| Sensor Type | Electrochemical, Electrochemical + Catalyst conversion |
| Sampling Method | Internal Pump |
| Detection Range | As per the attached list |
| Alarm Set Values | As per specifications |
| Response Time | T60: ≤60 seconds |
| Power Source | 4x AA Alkaline batteries, Approximately 12 hours, Approximately 8 hours (XDS-7NF) |
| Operating Temperature and Humidity | 0 to 40°C, 30 to 85%RH |
| Dimensions | 62 x 150 x 128mm |
| Weight | Approximately 1.3kg |
| Certifications | CE (EMC: 2014/30/EU) |
| Options | AC adaptor, Sensor stocker, Datalogger kit |

LIST OF TARGET GASES

| Type | Gas | Range | Type | Gas | Range |
|---------|----------------------------------|---------|---------|--------------------------------|---------|
| XDS-7NH | NH ₂ | 100 ppm | XDS-7HF | HF | 10 ppm |
| XDS-7SH | SiH ₄ | 25 ppm | XDS-7HB | HBr | 10 ppm |
| XDS-7DC | SiH ₂ Cl ₂ | 25 ppm | XDS-7NO | NO | 100 ppm |
| XDS-7AH | AsH ₃ | 250 ppm | XDS-7HS | H ₂ S | 50 ppm |
| XDS-7PH | PH ₃ | 1 ppm | XDS-7CO | CO | 250 ppm |
| XDS-7BH | B ₂ H ₆ | 50 ppm | XDS-7DS | Si ₂ H ₆ | 25 ppm |
| XDS-7SE | H ₂ Se | 25 ppm | XDS-7F2 | F ₂ | 5 ppm |
| XDS-7GH | GeH ₄ | 1 ppm | XDS-7OZ | O ₃ | 1 ppm |
| XDS-7CL | CL ₂ | 5 ppm | XDS-7SD | SO ₂ | 10 ppm |
| XDS-7CF | ClF ₃ | 1 ppm | XDS-7ND | NO ₂ | 10 ppm |
| XDS-7HC | HCl | 5 ppm | XDS-7NF | NF ₃ | 100 ppm |

AM-XP-704III Gas Leak Detector

PRODUCT FEATURES

- » Trace gas detectable with high sensitivity sensor
- » Automatic zero adjustment and stop pump functionality
- » Dedicated refrigerant gas detector



AM-XP-704III

| Model | AM-XP-704III |
|------------------------------------|---|
| Target gas | R-22, R-32, R-404A, R-407C, R-600a, R-410A, R-134a, R-290, HFO-1234yf |
| Sensor Type | Hot-wire semiconductor |
| Sampling Method | Internal Pump |
| Detectable Leak Rate | R-22: 2.84(g), R-32: 1.71 (g), R-404A: 3.3D(g), R-407C: 3.12(g), R600a: 1.91(g), R410A: 2.82(g), R-134a: 20.09(g), R-290: 1.45(g), HFO-1234yf: 3.74(g) (Pa·m ³ /s) |
| Detectable Gas Concentration | 5ppm (R-134a: 30 ppm) |
| Response Time | 10 seconds |
| Power Source | 2x AAA alkaline batteries Approximately 12 hours |
| Operating Pressure | Atmospheric pressure (800 to 1100 hPa) |
| Operating Temperature and Humidity | D to 40°C, 30 to 85 %RH |
| Dimensions | 38 x 135 x 32mm |
| Weight | Approximately 190g |
| Accessories | Soft case, Drain filter, Filter element, Gas probe, Dust filter, Hand strap, 2x AA Alkaline batteries |

AM-XP-703DIII Gas Leak Detector

PRODUCT FEATURES

- » Trace gas detectable with high sensitivity sensor
- » Automatic zero adjustment and stop pump functionality
- » Detects toxic gases



AM-XP-703DIII

| Model | AM-XP-703DIII |
|------------------------------------|---|
| Target gas | Hydrogen, Arsine, Diborane, Silane, Phosphine |
| Sensor Type | Hot-wire semiconductor |
| Sampling Method | Internal Pump |
| Detectable Leak Rate | H2: 5.07 x 10 ⁻⁷ , AsHa: 2.53 x 10 ⁻⁷ , B2Hs: 1.01 x 10 ⁻⁷ , SiH4: 2.53 x 10 ⁻⁷ , PHa: 1.52 x 10 ⁻⁷ (Pa·m ³ /s) |
| Detectable Gas Concentration | H2: 1.0 ppm, AsHa: 0.5 ppm, B2Hs: 0.2 ppm, SiH4: 0.5 ppm, PHa: 0.3 ppm |
| Response Time | 10 seconds |
| Power Source | 2x AAA alkaline batteries Approximately 12 hours |
| Operating Pressure | Atmospheric pressure (800 to 1100 hPa) |
| Operating Temperature and Humidity | 0 to 40 °C, 30 to 85 %RH |
| Dimensions | 38 x 135 x 32mm |
| Weight | Approximately 190g |
| Accessories | Soft case, Drain filter, Filter element, Gas probe, Dust filter, Hand strap, 2x AA Alkaline batteries |

AM-SDM-72/AM-SDM-73 Steel Dust Metre

PRODUCT FEATURES

- » Measures bearing, gear, and cylinder wear conditions
- » Monitors steel dust contamination in hydraulic oil and grinding oil
- » Ferrography and SOAP method pre-diagnosis



AM-SDM-72



AM-SDM-73

| Model | AM-SDM-72 | AM-SDM-73 |
|-----------------------|---|---|
| Measurement Principle | Magnetic balance type electromagnetic method | |
| Substance Measured | Steel dust concentration in grease | Steel dust concentration in lubricating oil |
| Measurement Range | 0 to 5.000 %Wt | 0 to 19999 wt ppm |
| Minimum Resolution | 0.001 %Wt | 1 wt ppm |
| Amount of Sample | Approximately 0.8 ml | 1.5ml |
| Power Source | 4 x AA Alkaline batteries, Approximately 30 hours | |
| Certifications | CE | |
| Operating Temperature | 0 to 40°C | |
| Dimensions | 84 x 190 x 40mm | |
| Weight | Approximately 500g | |
| Accessories | Carrying case, Grease sampling spatula, Grease sample case (10 pieces), and 4 x AA Alkaline batteries | Carrying case, 2 ml syringe (5 pieces), Oil sampling nozzle (2 pieces), Syringe holder, and 4 x AA Alkaline batteries |

Others

AM-XP-329m Odour Level Indicator

PRODUCT FEATURES

- » Detects and visualises various odours
- » No maintenance, disposable type
- » Detects lithium-ion battery electrolytes



AM-XP-329m

| Model | AM-XP-329m |
|------------------------------------|---|
| Target gas | Various odors, Odor components |
| Sensor Type | Tin oxide-based high sensitivity hot wire semiconductor sensor |
| Sampling Method | Internal Pump |
| Indicated Value | 0 to 999 |
| Operating Temperature and Humidity | 0 to 40°C, 10 to 80 %RH |
| Dimensions | 60 x 140 x 40mm |
| Weight | Approximately 300g |
| Power Source | 3x AA alkaline batteries or AC adaptor (AC100-240 V) Approximately 10 hours |
| Accessories | Drain filter, 3 x AA alkaline batteries, Filter elements (10 pcs) |
| Options | Activated carbon filter (DF-105), Activated carbon (FE-110), AC adaptor |

AM-XP-329IIIR Odour Level Indicator

PRODUCT FEATURES

- » Detects and visualises various odours
- » Switch between continuous monitoring mode with real-time display and 1 minute batch measurement mode
- » Equipped with an activated carbon filter for automatic zero adjustment
- » Sensor status bar graph display shows when maintenance is required



AM-XP-329IIIR

| Model | AM-XP-329IIIR |
|------------------------------------|--|
| Target gas | Various odours, Odour components |
| Sensor Type | Indium oxide-based sensitivity hot wire semiconductor sensor |
| Sampling Method | Extractive *Extractive flow: 400± 150ml/min |
| Display | LCD digital indication (64 x 128 dots matrix) (measurement value, measurement mode, operating conditions, remaining battery level, data memory, bar indication for sensor output and communication channel etc.) |
| Measurement Mode | Monitoring mode/Batch mode |
| Indicated Value | Level indication: 0-2000 (In case of zero-based setting at the 2nd dot from the left in the sensor output bar graph) |
| External Output | Analog output: DC0-200 mV. Digital input/output: RS-232C output the indicated value (ASCII Code) |
| Operating Temperature and Humidity | 0 to 40°C 10 to 80 %RH |
| Dimensions | 84 x 275 x 40mm |
| Weight | Approximately 640g |
| Power Source | 4x AA alkaline batteries or AC adaptor, Approximately 8 hours |
| Accessories | Tube intake, AC adaptor, Output connector, Accessories Communication pack (CD), 4x AA Alkaline batteries, Teflon tube (1 m), 2 x Activated carbons, 2 x Filter elements (10 pcs.) |

AM-XP-3320II-V Real-Time VOC Monitor

PRODUCT FEATURES

- » Real-time VOC monitoring
- » Converts to detect 92 different gases^{*1}
- » Trend graphs displayable directly on device or on dedicated app^{*2}
- » Significantly improved impact resistance

*1 Reference value

*2 Optional log data collection software (sold separately) is required to read log data on PC.



AM-XP-3320II-V

| Model | AM-XP-3320I-V |
|------------------------------------|--|
| Target gas | VOC calibration gas: Toluene |
| Gas Sampling Method | Automatic suction-type |
| Sensor Type | Hot wire semiconductor |
| Detection Range | 0-1000 ppm |
| Power Source | 4 AA alkaline batteries or 4 AA size nickel-metal hydride rechargeable batteries |
| Continuous Use Time ^{*1} | Approximately 22 hours |
| Operating Temperature and Humidity | 0 to +40°C, 85% RH or less (However, there should be no condensation or sudden changes in temperature or humidity.) |
| Certifications | Alkaline battery specifications: Ex ia da IIC T4 Ga Nickel-metal hydride battery specifications: Ex ia da IIC T3 Ga |
| Protection Rating | IP67 equivalent |
| Wireless Communication | Bluetooth 5.0 |
| External Dimensions | 91 x 164 x 44mm (excluding protrusions) |
| Weight | Approximately 460g (including batteries) |
| Standard Accessories | Shoulder belt, 1 m gas sampling hose for solvents, filter element, LCD protective film, alkaline battery (or nickel-metal hydride battery) |

AM-XV-389 VOC Monitor

PRODUCT FEATURES

- » Select target gas from 17 available VOCs
- » Alarm levels (TWA, STEL) can be set for selected VOCs
- » Monitors the instantaneous values, average values, TWA, and STEL values of voes in the air in real time



AM-XV-389

| Model | AM-XV-389 |
|------------------------------------|--|
| Target gas | 17 types of VOC (Calibration gas: Toluene) |
| Sensor Type | Hot-wire semiconductor |
| Detection Range | Extractive *Extractive flow: 400± 150ml/min |
| Display Resolution | 1 ppm |
| Alarm Set Value | TWA Alarm Exposure limit of eight-hours STEL Alarm Exposure limit of short time (15 minutes) Depends on gas type |
| Power Source | 1x AAA alkaline dry battery, Approximately 30 hours |
| Operating Temperature and Humidity | -10 to 40°C, 30 to 85 %RH |
| Certifications | IP52 |
| Dimension | 94 x 40 x 20mm |
| Weight | Approximately 73g |
| Accessories | 1x AAA alkaline battery, 1x Safety pin adaptor, Sensor cover with filter |

Gas Detector Heads

AM-KD-12 Series Diffusion Type Gas Detector Head with Display

PRODUCT FEATURES

- » Rugged, compact, and lightweight
- » Explosion proof
- » Water and dust proof (IP65)
- » Easy sensor replacement
- » Multiple models available (HART, SIL2, Suction type)

EXTERNAL DIMENSIONS (UNITS:MM)

AM-KD-12A/B/C/B-S IL

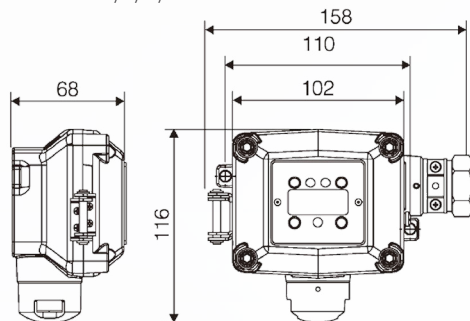

AM-KD-120/0/R

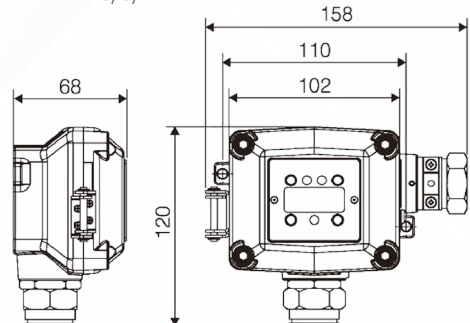

ATEX certified models

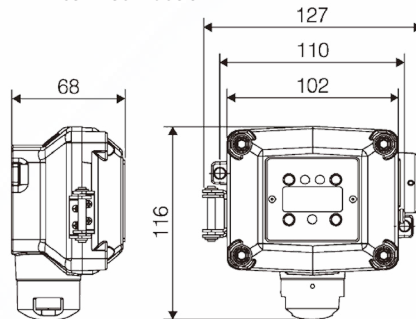

AM-KD-12B



| Model | AM-KD-12A | AM-KD-12B | AM-KD-12C | AM-KD-12R |
|-----------------------|---|------------|----------------------------------|-------------------------|
| Target gas | Combustible gas, Toxic gas | | Hydrogen, Helium, Carbon Dioxide | Methane, Carbon Dioxide |
| Sensor Type | Hot wire semiconductor | Combustion | Thermal conductivity | NDIR |
| Detection Range | ppm | %LEL | vol% | ppm, %LEL, vol% |
| Power Supply | 24 VDC (±20%) | | | |
| Power Consumption | 3W maximum | | | |
| Repeatability | F.S: ±20% | F.S: ±5% | F.S: ±5% | F.S: ±10% |
| External Output | Gas concentration analog signal: 4-20 mADC (common to the negative side of power supply) Gas alarm contact (one stage only): 1 a no-voltage contact output, Non-latching, HART Communication Protocol Rev. 7.5 (option) •except KD-12C | | | |
| Certifications | II 2 G Ex db IIC T5 Gb (ATEX) Ex db IIC T5 Gb (IECEX) Ex d IIC T5 (Japan EX) | | | |
| IP Rating | IP65 | | | |
| Operating Temperature | -10 to +50 °C | | | |
| Operating Humidity | 10 to 90 %RH (0 to 50 °C) | | | |
| Weight | Approximately 1.2 kg | | Approximately 1.3 kg | |

- *1. Only combustible gas for ATEX certified models
- *2. Screwless type only
- *3. No rapid temperature change
- *4. No rapid humidity changes, No condensation

- *1. KD-12A/B/C/D/R/0
- *2. KD-12NB
- *3. KD-12NB/C/0

| Model | AM-KD-12D | AM-KD-120 | AM-KD-12B-SIL | AM-KD-12AH/BH |
|-----------------------|---|------------------|--|----------------------------|
| Target gas | Carbon monoxide | Hydrogen sulfide | Oxygen | Combustible gas, Toxic gas |
| Sensor Type | Electrochemical cell | Galvanic cell | Combustion | Hot wire semiconductor |
| Detection Range | ppm | vol% | %LEL | ppm |
| Power Supply | 24 VDC (±20%) | | | |
| Power Consumption | 3W maximum | | | |
| Repeatability | F.S: ±10% | ±0.5vol% | F.S: ±5% | F.S: ±20% |
| External Output | Gas concentration analog signal: 4-20 mADC (common to the negative side of power supply) Gas alarm contact (one stage only): 1 a no-voltage contact output, Non-latching, HART Communication Protocol Rev. 7.5 (option) •except KD-12C | | | |
| Certifications | II 2 G Ex db IIC T5 Gb (ATEX) Ex db IIC T5 Gb (IECEX) Ex d IIC T5 (Japan EX) | | II 2 G Ex db IIC T5 Gb (ATEX), Ex db IIC T5 Gb (IECEX) | |
| IP Rating | IP65 | | | |
| Operating Temperature | -10 to +40 °C | 0 to +40 °C | -10 to +40 °C | |
| Operating Humidity | 30 to 85 %RH | | 10 to 90 %RH (0 to 50 °C) | |
| Weight | Approximately 1.3 kg | | Approximately 1.2 kg | |

AM-PD-12 Series Suction Type Gas Detector Head with Display

PRODUCT FEATURES

- » Suction type with hydrogen explosion proof
- » Explosion proof
- » Water and dust proof (IP65)
- » Easy sensor replacement

EXTERNAL DIMENSIONS (UNITS:MM)

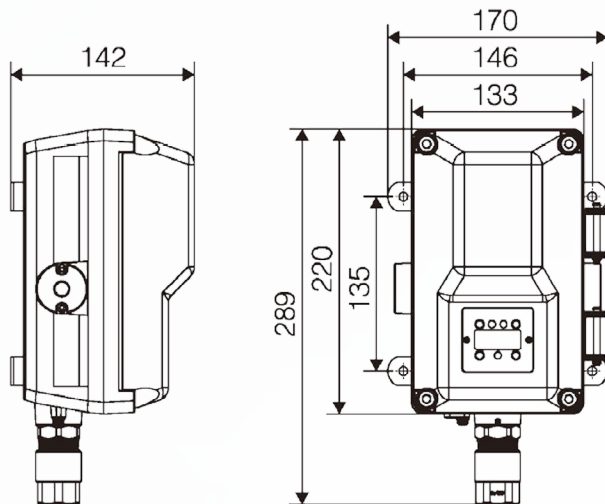

AM-PD-12

| Model | AM-PD-12A | AM-PD-12B | AM-PD-12C |
|-----------------------|---|-------------------------------|----------------------|
| Target gas | | Combustible as toxic as, etc. | |
| Sensor Type | Hot wire semiconductor | Combustion | Thermal conductivity |
| Detection Range | ppm | %LEL | vol% |
| Repeatability | F.S: ±20% | | F.S: ±5% |
| Power Supply | 24 VDC (18 to 30 VDC) | | |
| Power Consumption | 7.5 W maximum | | |
| Flow Rate | Over 0.5 L/min | | |
| External Output | 4-20 mADC (common to the negative side of power supply), 1 a no-voltage contact output (Automatic return) | | |
| Certifications | 112 G Ex db IIB +H2 T4 Gb (ATEX) •1 Ex d IIB + H2 T4 X (Japan EX) | | |
| IP Rating | IP65 | | |
| Operating Temperature | -10 to +50 °C | | |
| Operating Humidity | 10 to 90 %RH (0 to 50 °C) | | |
| Weight | Approximately 5.2 kg | | |

AM-PS-8 Series Semiconductor Gas Detector

PRODUCT FEATURES

- » Long-life Sensors
- » Integrated thermal decomposition converter
- » Large LCD display for easy visual verification

EXTERNAL DIMENSIONS (UNITS:MM)

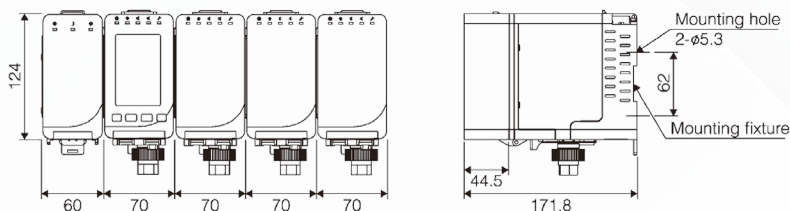

AM-PS-8

| Model | Main Unit | | Sub-Unit |
|--|--|---|--|
| | AM-PS-8N | AM-PS-8M | AM-PS-8S |
| Target gas | Combustible gas, Toxic gas, Oxygen | | |
| Display | Monochrome LCD full dot display Gas concentration: 5- digit display (with units of measurement), Others: gas name, flow rate status, first and second stage alarm indicator, fault alarm | | None (Main Unit contains display) |
| Digital signal | When using the expansion unit MR module RS485 (Modbus-RTU) | Ethernet 10BASE-T/100base-Tx (Modbus/TCP) Modbus/TCP (Maximum number of connections depends on system configuration) Maximum transmission distance 100m (to HUB) | — |
| External Output | Gas concentration analog signal | DC4-20 mA (common negative with power source) (Output accuracy: within FS \pm 0.5%), *0.6 mA or less when a fault alarm indication occurs, *The resistance, including wiring resistance, must be 300 Ω or less | — |
| | Combined gas alarm contact (1st and 2nd stage), Combined fault alarm indication contact | 1 a non-voltage contact/automatic return, *Rated load: AC125V 0.5A or DC30V 1.0A (resistive load), *Individual contact outputs require an expansion unit. | — |
| Operating Temperature and Humidity Range | 0 °C to 40 °C (with no sudden changes), 30 to 85%RH (with no condensation) | | |
| Power Source Used | DC24V \pm 10% | DC24V \pm 10% or PoE (Power over Ethernet, IEEE 802.3at) | Supplied from the main unit |
| Dimensions | 70 x 124 x 172mm | | |
| Weight | Approximately 850g (excluding sensor) | | Approximately 770g (excluding sensor unit) |

| Model | | Expansion unit (up to 2 modules can be installed) | | | |
|--|--------------|---|---|---|--|
| | | AM-PS-8EU | | | |
| Module | | AO module (analog output) | DO module (contact output) | MR module (Modbus-RTU) | AI module (analog input) |
| External Output | Signal type | Gas concentration analog signal | Gas alarm contact (1- stage and 2- stage), fault alarm indication contact | Modbus-RTU (Maximum number of connections: 32 (including master)) | — |
| | Output | DC4-20mA (Common negative terminal with power source) (Output accuracy: within FS \pm 0.5%) *o.6 mA or less when a fault alarm indication occurs *The resistance, including wiring resistance, must be 300 Ω or less | 1 a non-voltage contact/automatic return *Rated load 125 VAC 0.5 A or 30VDC 1.0 A (Resistive load | Communication method: RS485 2- wire half duplex Maximum transmission distance: 1.2 km (to host device) Speed: 4800bps, 9600 bps, 19200 bps, 38400 bps | |
| Internal Output | Signal Type | | | | 4-20 mA analog input |
| | Input Number | | — | | 2 |
| | Input | | | | 0-21.6mA |
| External connection terminal compatibility/cable | | Terminal block (12pin x 1, 1 pin x 1), Compatible cables: CW-S 1.25 mm ² and others | Terminal block (12 pin x 1), Compatible cables: CW-S 1.25 mm ² and others | Terminal block (3pin x 1, 1pin x 2), Compatible cables: CW-S 1.25mm ² and others twisted air shielded cable | Terminal block (3pin x 2, 1pin x 1), Compatible cables: CVVS 1.25 mm ² and others |
| Operating Temperature and Humidity Range | | 0 °C to 40 °C (with no sudden changes), 30 to 85%RH (with no condensation) | | | |
| Power Source Used | | Supplied from the main unit | | | |
| Dimensions | | 60 x 124 x 172mm | | | |
| Weight | | Approximately 410g | | | |

*1. Modbus-RTU can be used with Ethernet or dispersion unit. *2. The Main Unit analog output is limited to the Main Unit. The Sub Unit sensor analog output requires the AO expansion module. The AO expansion module can output analog signals from the Main Unit allowing for multiple connections. *3. When installing two or more sensors using a Sub Unit and using individual contact output, use a DO expansion module. In this case, the individual outputs for the sensors installed in the Main Unit will be output from the expansion unit (the main unit's contacts will be output all at once).



AM-COD-203 Odour (Environment) Detector

PRODUCT FEATURES

- » Creates visualisation of environmental air quality
- » Continuous monitoring of chemical substances in clean rooms
- » Built-in ultra-sensitive sensor
- » Compact and lightweight

EXTERNAL DIMENSIONS (UNITS:MM)

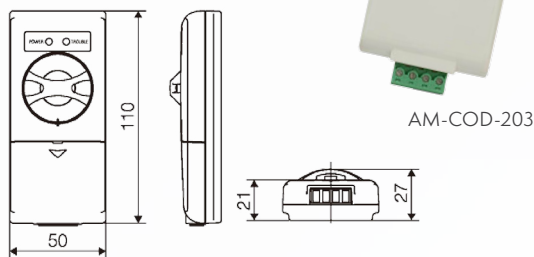

| Model | AM-COD-203A | AM-COD-203B |
|-----------------------|------------------------|--------------------|
| Calibration Gas | Ethanol | Toluene |
| Sensor Type | Hot wire semiconductor | |
| Power Supply | DC24 V \pm 6 V | |
| Power Consumption | Approximately 2W | |
| External Output | Analog 4 to 20 mA DC | |
| Full Scale | 100ppm | 200ppm 200ppm 5ppm |
| Recommended Location | Indoor/ Working place | Clean room |
| Operating Temperature | 5 to +35 °C | |
| Operating Humidity | 30 to 85 %RH | |
| Weight | Approximately 0.2 kg | |

AM-PS-7/AM-PS-7M Series Semiconductor Gas Detector

PRODUCT FEATURES

- » Automatic sampling flow control
- » Easy sensor and pump replacement
- » Capable of detecting a wide range of gases by changing the sensor unit

EXTERNAL DIMENSIONS (UNITS:MM)

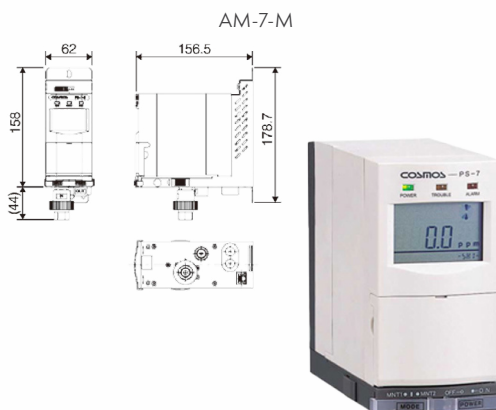
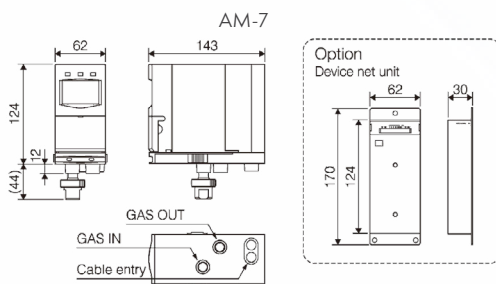

| Model | AM-PS-7 | AM-PS-7-M |
|-----------------------|---|--|
| Target Gas | Combustible gas, Toxic gas, Oxygen | |
| Sensor Type | Electrochemical cell, Hot wire semiconductor, Galvanic cell, Catalytic combustion | |
| Transport System | Flow rate: 0.5 ml/min, Teflon, 4 mm in ID x 6 mm in OD, Length: Up to 20 m | |
| Power Supply | 24 VDC \pm 10% | 24 VDC \pm 10%, PoE (Power over Ethernet, IEEE 802.3af/ANSI X3.263) |
| Power Consumption | Approximately 6W | Approximately 9W |
| Alarm Indication | <ul style="list-style-type: none"> » Gas alarm (1st and 2nd stage) » Low flow alarm » Sensor trouble alarm/Incorrect sensor inserting alarm » Pyrolyzer wire break alarm (Only for the model with a pyrolyzer.) | |
| External Output | <ul style="list-style-type: none"> » 4-20 mADC (shared with the power source negative terminal) » Gas alarm contact (1st and 2nd): 1a no-voltage contact/Non-latching » Fault contact (Open collector/Non-latching) | <ul style="list-style-type: none"> » Digital signal Ethernet100base-Tx (Modbus/TCP) » Digital signal RS-485 (Modbus/RTU) |
| Applicable Cable | <ul style="list-style-type: none"> » 3C or 4C shielded control cable (<math>\leq 118-11\text{ mm}</math>) x 2 » Digital signal Ethernet100base-Tx and PoE: LAN cable, CAT-5e or higher (PS-7M) | |
| Operating Temperature | 0 to +40 °C | |
| Operating Humidity | 30to85 %RH | |
| Weight | Approximately 1.0 kg | Approximately 1.3 kg |

AM-PD-14A/AM-PD-14B Suction Type Gas Detector Head



AM-PD-14B

| Model | AM-PD-14A | AM-PD-14B |
|-----------------------|--|-----------|
| Target Gas | Combustible gas, Toxic gas, etc. | |
| Sensor Type | Hot wire semiconductor | Catalytic |
| Detection Range | ppm | %LEL |
| Repeatability | ±20% | F.S: ± 5% |
| Detection Range | As per specifications | |
| Power Supply | 24 voe (18 to 30 voe) | |
| Applicable Cable | Cable outer diameter: 10.5 mm to 14.5 mm 6-conductor shielded cable: CW-S 1.25mm ² or 2.0mm ² | |
| Certifications | Ex d IIB + H2T4 (Japan Ex) | |
| IP Rating | IP65 | |
| Operating Temperature | -10to +50 °C | |
| Operating Humidity | 10 to 90 %RH | |
| Dimensions | 133 x 260 x 132mm | |
| Weight | Approximately 5.2 kg | |

AM-PE-2CC/AM-PE- 2DC Suction Type Gas Detector Head



AM-PE-2CC

| Model | AM-PE-14A | AM-PE-14B |
|-------------------------|---|-------------|
| Target Gas | Combustible gas, Toxic gas, etc. | |
| Sensor Type | Hot wire semiconductor, Catalytic or Thermal conductivity | |
| Detection Range | As per specifications | |
| Power Source for Sensor | Supplied from the indicator unit | |
| Power Source for Pump | 100 VAC ±10% | 24 VDC ±10% |
| Certifications | d2G4 | |
| Operating Temperature | -10 to +40 °C | |
| Operating Humidity | 30 to 85 %RH | |
| Applicable Cable | 6C shielded cable: CW-S 0.75mm ² to 2.0mm ² | |
| Dimensions | 122 x 290 x 196mm | |
| Weight | Approximately 6.2 kg | |

AM-KD-5A/AM-KD-5B Diffusion Type Gas Detector Head



AM-KD-5A

| Model | AM-KD-5A | AM-KD-5B |
|-------------------------|---|----------|
| Target Gas | Combustible gas, Toxic gas, etc. | |
| Sensor Type | Hot wire semiconductor, Catalytic or Thermal conductivity | |
| Detection Range | As per specifications | |
| Power Source for Sensor | Supplied from the indicator unit | |
| Certifications | d3aG4 | d2G4 |
| Operating Temperature | -10 to +60 °C | |
| Operating Humidity | 10 to 85 %RH | |
| Dimensions | 141 x 192 x 194mm | |
| Weight | Approximately 1.0 kg | |

AM-KS-2D-N/AM-KS-20-N Diffusion Type Gas Detector Head



AM-KS-2D-N

| Model | AM-KS-2D-N | AM-KS-20-N |
|-------------------------|---|---------------|
| Target Gas | Toxic gas | Oxygen |
| Sensor Type | Electrochemical | Galvanic cell |
| Detection Range | As per specifications | |
| Power Source for Sensor | Supplied from the indicator unit Power Source | |
| Operating Temperature | 0 to +40 °C | |
| Operating Humidity | 30 to 85%RH | |
| Dimensions | 102 x 200 x 75mm | |
| Weight | Approximately 1.5 kg | |

AM-PS-2DP-N/AM-PS-2DE-Ex Suction Type Gas Detector Head



AM-PS-2 Series

| Model | AM-PS-2DP-N | AM-PS-2DE-Ex |
|-------------------------|--|--|
| Target Gas | Toxic gas | |
| Sensor Type | Electrochemical | |
| Detection Range | As per specifications | |
| Power Source for Sensor | Supplied from the indicator unit | |
| Power Source for Pump | 100 VAC \pm 10% or 24 VAC \pm 10% | — |
| Air Supply | — | Instrumentation air 0.3 MPa |
| Certifications | Non-explosion-proof | Intrinsically safe explosion-proof 3nG5 when combined with a Zener barrier. |
| Operating Temperature | 0 to +40 °C | |
| Operating Humidity | 30 to 85 %RH | |
| Applicable Cable | 2C+2C shielded cable: CVV-S 0.75 mm ² to 2.0 mm ² shielded | 2C shielded cable: CVV-S 0.75 mm ² to 2.0 mm ² shielded |
| Certifications | 300 x 350 x 100mm | |
| Weight | Approximately 5.0 kg | |

AM-PS-20P-N/AM-PS-20E-Ex Suction Type Gas Detector Head

*Same product shown/listed above.



| Model | AM-PS-20P-N | AM-PS-20E-Ex |
|-------------------------|--|--|
| Target Gas | Oxygen | |
| Sensor Type | Galvanic cell | |
| Detection Range | As per specifications | |
| Power Source for Sensor | Supplied from the indicator unit | |
| Power Source for Pump | 100 VAC \pm 10% or 24 VAC \pm 10% | — |
| Air Supply | — | Instrumentation air 0.3 MPa |
| Certifications | Non-explosion-proof | Intrinsically safe explosion-proof 3nG5 when combined with a Zener barrier. |
| Operating Temperature | 0 to +40 °C | |
| Operating Humidity | 30 to 85 %RH | |
| Applicable Cable | 2C+2C shielded cable: CVV-S 0.75 mm ² to 2.0 mm ² shielded | 2C shielded cable: CVV-S 0.75 mm ² to 2.0 mm ² shielded |
| Certifications | 300 x 350 x 100mm | |
| Weight | Approximately 5.0 kg | |

AM-VAS/AM-V3 Series Panel Mount Unit

PRODUCT FEATURES

- » LED bar graph for easy alarm status checking
- » Compatible with existing indicator units
- » Various outputs to external devices

EXTERNAL DIMENSIONS (UNITS:MM)

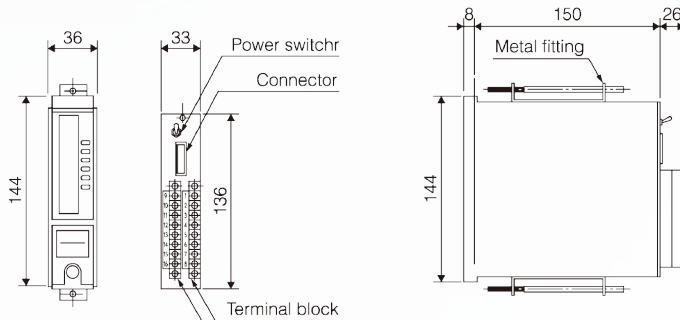

AM-VAS/AM-V3

| Model | AM-VAS | |
|-----------------------|---|--|
| External Output | Alarm Contact | 1c no-voltage for 1st and 2nd stage alarm (100 VAC/1 A resistance load) |
| | Trouble Contact | 1a no-voltage (100 VAC/1 A resistance load, 24 VDC, 1 A resistance load) |
| | Buzzer Contact | |
| Power Supply | 24 voe $\pm 10\%$ | |
| Power Consumption | Approxiamtely 3.5W (24V for alarm) | |
| Operating Temperature | -10 to +40 °C | |
| Operating Humidity | 10 to 90 %RH | |
| Weight | Approxiamtely 600g (including 450g single case) | |

| Model | AM-V3 | |
|-----------------------|---|-------------------------------|
| Type | Hv, Hi, Cv, Ci, Tv, Ti, D, O | |
| Alarm Levels | Adjustable within the detection range for 1st and 2nd stage alarm | |
| Power Supply | 24 voe $\pm 10\%$ | |
| Power Consumption | Approximately 4.0W (excluding power consumption of extractive gas detector) | |
| External Output | Contact Output | 1 c no-voltage, 1 a for fault |
| | Analog Output | 4-20 mADC |
| Operating Temperature | -10 to +40 °C | |
| Operating Humidity | 10 to 90 %RH | |
| Weight | Approximately 600g (including 450g single case) | |

AM-UV-810 Series Indicator Panel

PRODUCT FEATURES

- » Connect up to 15 V3 indicator units
- » Wide variety of input power sources and external outputs

| Model | AM-UV-810/ AM-UVB-810 |
|---------------------------|---|
| Number of Indicator Units | Up to 15 points (line up: 3/6/9/12/15 point type) |
| External Outputs | Terminal for collective alarm <ul style="list-style-type: none"> » Alarm1, Alarm2, Fault » Energised/de-energised & latching,non-latching *Collective alarm contacts of 1st alarm and 2nd alarm can be changed to 1 b contact (need to specify) Terminal for individual alarm <ul style="list-style-type: none"> » Alarm1, Alarm2, Fault Analog output <ul style="list-style-type: none"> » Gas concentration analog output signal: 4-20 mA, selectable from 1-5 V (need to specify) |
| Power Supply | AC specification: 100-240 VAC \pm 10% DC specification: 24 VDC \pm 10% (need to specify) |
| Operating Temperature | -10 to +40 °C (excluding rapid temperature change) |
| Operating Humidity | 10 to 90 %RH (excluding rapid temperature change, non-condensing) |
| Weight | UV-810=5.5-13.5 kg UVB-810=8.0-16 kg (depends on the number of units) |

| Model | Mounting Points | Dimensions of Width (mm) |
|---------|-----------------|--------------------------|
| AM-810 | 3 | 236 |
| | 6 | 350 |
| | 9 | 526 |
| | 12 | 640 |
| | 15 | 814 |
| AMB-810 | 3 | 414 |
| | 6 | 642 |



AM-UV-810

EXTERNAL DIMENSIONS (UNITS:MM)

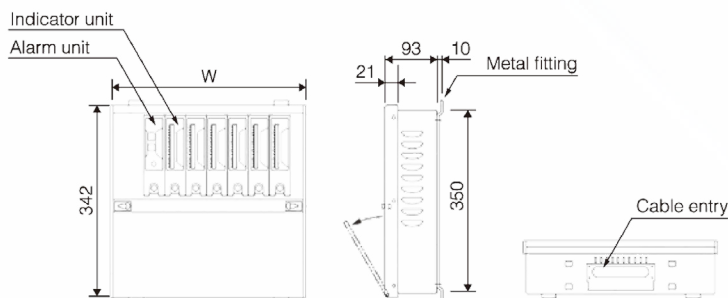

AM-NV-120 Series Single Point Gas Alarm System

PRODUCT FEATURES

- » Colour LCD for gas concentration display and various settings
- » Voiced alarm available in 4 languages
- » Equipped with jog dial for improved operability

EXTERNAL DIMENSIONS (UNITS:MM)

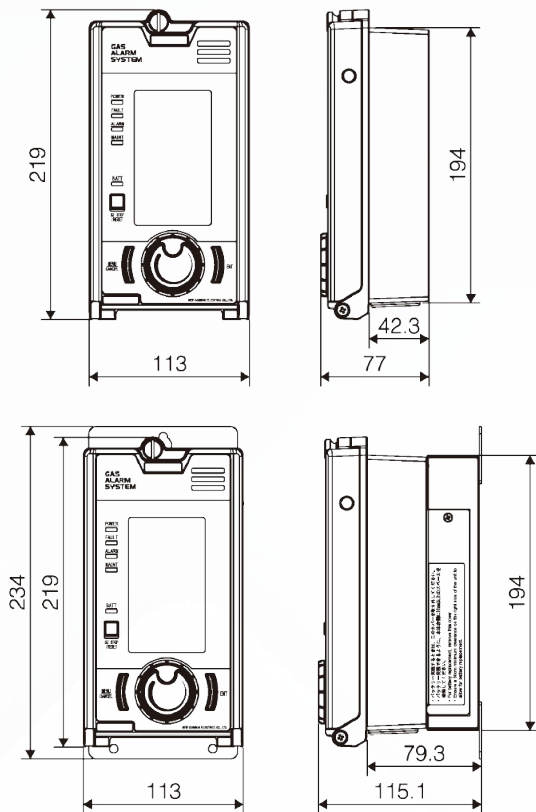

AM-NV-120Hv

| Model | AM-NV-120Mx | AM-NV-120Cv | AM-NV-120Ci | AM-NV-120Hv | AM-NV-120Hi | AM-NV-120Dx | AM-NV-120Sx |
|-----------------------|--|--------------------|-------------|--------------------|-----------------|-----------------|-----------------|
| Connectable Detectors | KD-12 PD-12 | KD-5A-N KD-5B-N | PE-2DC | KD-5A-N KD-5B-N | KD-14 PE-2DC | KS-2D PS-2DP | KS-2O PS-2OP |
| Power Supply | AC type: 100 to 240 VAC $\pm 10\%$ or DC: 24 voe (18 to 26.4 VDC) | | | | | | |
| Power Consumption | Non-backup power type: 2.0 VA (Standard)/3.4 VA (Max), Backup power type: 2.1 VA (Standard)/4.7 VA (Max) | | | | | | |
| | » Power output: 24 voe $\pm 10\%$ Max.0.3 A | | | | | | |
| Operating Humidity | » Signal output: 4-20 mA analog or 1-5 V [*] In the event of failure:~ 0.6 mA (for 4-20 mA type) and~ 0.25 V (for 1-5 V type) | | | | | | |
| | » Alarm1, Alarm2, Fault | | | | | | |
| | » Energised/de-energised & latching, non-latching | | | | | | |
| Dimensions | Non-backup power type: -10 to +50 °C, Temperature Backup power type: 0 to +40 °C | | | | | | |
| Weight | 0 to 90 %RH | | | | | | |
| Dimensions | Non-backup power type: 113x 77 x 219mm, Backup power type: 113mm x 115 x 234mm | | | | | | |
| Weight | Non-backup power type: Approximately 750g, Backup power type: Approximately 2.2kg | | | | | | |

AM-NV Series Multi Point Gas Alarm System

PRODUCT FEATURES

- » 2 day backup power supply (optional)
- » Easy operation
- » Robust design
- » Voiced alarms available in 4 languages (Japanese, English, Chinese, Korean)

EXTERNAL DIMENSIONS (UNITS:MM)

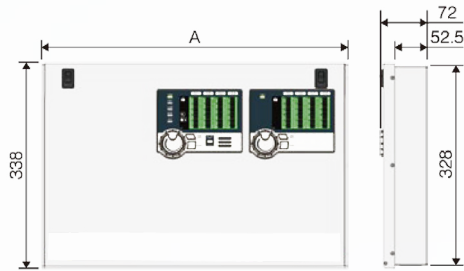

Cut Recess Panel Dimensions

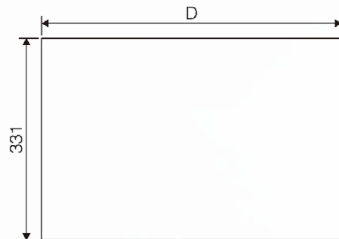

AM-NV-520

| Number of Detection Head Points | A | D |
|--|-----|-------|
| 2 point system without backup power source | 221 | 215±1 |
| 2 point system with backup power source supply specification/ 4 point system | 299 | 293±1 |
| 6 point system/ 8 point system | 496 | 490±1 |
| 10 point system/ 12 point system | 644 | 638±1 |

| Model | AM-NV-520 | AM-NV-400/410 | AM-NV-600/600HS |
|---------------------------|--|------------------------|--|
| Target Gas | LPG (%LEL) | Methane (%LEL) | NV-600: Combustible gas (%LEL) NV-600HS: Combustible gas (ppm and %LEL) |
| Connectable Detectors | Diffusion type: KD-5A-N/KD-5B-N, KD-14, Extractive type: PE-2DC, PD-14 | | |
| Number of Indicator Units | Up to 12 units | | |
| Sensor Type | Catalytic | Hot wire semiconductor | Catalytic/Hot wire semiconductor |
| Power Supply | AC type: 100 to 240 VAC±10% or DC: 24 voe (18 to 26.4 VDC) | | |
| External Output | Individual Alarm Contact | Alarm1, Alarm2 | |
| | Individual Voltage Output | 0-6-12 VDC | |
| | Collective Alarm Contact | Alarm1, Alarm2 | |
| | Centralized Monitor Panel Output | 0-6-12 VDC | |
| | External Buzzer Contact | Alarm1, Alarm2 | |
| | External Buzzer Voltage Output | 12 VDC | |
| Operating Temperature | -10to50 °C | | |
| Operating Humidity | 0 to 90 %RH | | |
| Weight | As per specifications 5.0 kg~ | | |
| Options | External buzzer, Panel mounting attachment | | |

AM-B-780/AM-KD-5 Simplified Gas Alarm System

PRODUCT FEATURES

- » Compact and light weight
- » Connect with up to 3 detector heads
- » Easy sensor status check

ALARM UNIT

| Model | AM-B-780 |
|-------------------------------|--|
| Target Gas | Methane (LNG)/LPG |
| Power Voltage | AC 100V/220V $\pm 10\%$ 50/60Hz |
| Number of Connected Detectors | Up to 3 units |
| Connectable Detectors | KD-5G , KD-5GM |
| External Outputs | 6 VDC at normal operation, 12 VDC at gas alarm, and 0 VDC at fault alarm 100/220 VAC, 1 A Alarm Energised/de-energised |
| Weight | 420g |
| Operating Temperature | -10 to 40 °C |



AM-B-780

DETECTOR HEAD

| Model | AM-KD-5G | AM-KD-5GM |
|-----------------------|-------------------|-----------|
| Target Gas | LPG | Methane |
| Detection Range | 1/100 to 1/4 %LEL | |
| Power Supply | 24V DC $\pm 20\%$ | |
| Certifications | d2G4 | |
| Operating Temperature | -10 to +60 °C | |
| Weight | Approx. 1.5 kg | |



AM-KD-5

EXTERNAL DIMENSIONS (UNITS:MM)

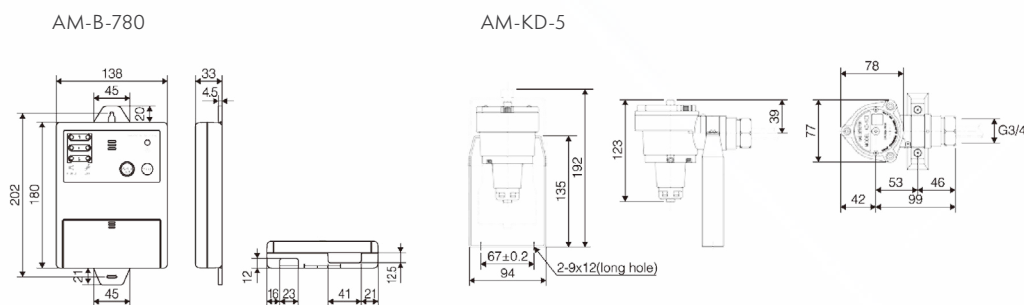

AM-KS-7 Series Single Point Gas Detector with Indicator and Alarm

PRODUCT FEATURES

- » LED lights for clear alarm indication
- » Automatic backup power for more than 2 weeks (350 hrs.)
- » Compact, lightweight, and easy to install

EXTERNAL DIMENSIONS (UNITS:MM)

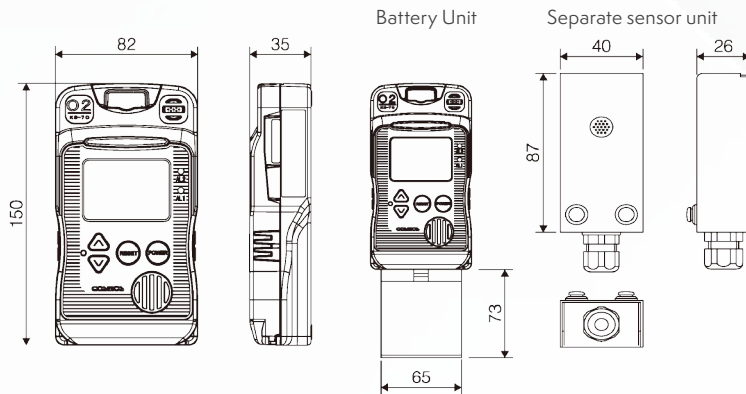

AM-KS-7D

| Model | AM-KS-7O | AM-KS-7D | AM-KS-7R |
|----------------------------|--|--|---------------------------------|
| Target gas | Oxygen | Carbon Monoxide | Carbon Dioxide |
| Sensor Type | Galvanic cell | Electrochemical | NDIR |
| Detection Range | 0 to 25.0 vol% or 0 to 50.0 vol% | 0 to 75 ppm, 0 to 150 ppm, 0 to 250 ppm, or 0 to 4000 ppm | 360 to 5,000 ppm |
| Power Supply | 24 VDC \pm 10% | | |
| Power Consumption | Monitoring: 1 W, During alarm: 3W | | |
| Alarm Set Value | For 25.0 vol%: 1st stage 19.0 vol% 2nd stage: 18.0 vol% For 50.0 vol%: 1st stage 18.0 vol% 2nd stage: 25.0 vol% | For F.S. 75 ppm: 25/50 ppm For F.S. 150 ppm: 50/100 ppm For F.S. 250 ppm: 50/150 ppm For F.S. 400 ppm: 50/150 ppm | AL 1: 2,000ppm AL2: 5,000ppm |
| External Output | Gas concentration analog output: 4-20 mA DC, Alarm1, Alarm2, Fault, Latching, non-latching | | |
| Operating Temperature | -10 to +40 °C | -5 to +40 °C | -10 to +50 °C |
| Operating Humidity | 30 to 85 %RH | | |
| Weight | Approximately 300g | | |
| Options (No CE marking) | Separate Sensor Unit (KS-7OF) Battery Unit KS-7xB | Battery Unit KS-7xB | Battery Unit KS-7xB |



More safety barrier solutions and signage available.
 Contact us on **1300 222 862** or sales@accumax.com.au to learn more.
accumax.com.au