



Accumax
Global Pty Ltd

Providing solutions to manage & reduce RISK!

Edition 4



MAXSafe

SCAFFOLD

INSPECTION TAG

MAXBund

MAXSafe

MAXChock

SCAFFOLD INSPECTION TAG

This newly developed and commissioned Scaffold Inspection Tag has been designed with input from leading industry veterans with a view to simplifying the whole Scaffold Tag process.

The MAXSafe® Scaffold Tag eliminates the limitations of the traditional scaffold tag, by not having to be hung on the scaffold tube. This means that the MAXSafe® Scaffold Tag does not need to be cut or modified to fix in the best place in every situation.

- ✓ Ultra tough poly construction, virtually untearable
- ✓ Scaffolder friendly
- ✓ All in one tag
- ✓ Meets and exceeds AS standards
- ✓ Clear message; Green for Go and Red for Stop
- ✓ Extremely versatile – not limited to where, or how to hang it
- ✓ Cost effective and re-usable
- ✓ Total message on one page
- ✓ Clear to all persons who access scaffold – not just scaffolders
- ✓ High wind resistance
- ✓ Impervious to dust, dirt and grime

MAXSafe® Scaffold Inspection Tags don't need to be removed or altered throughout the scaffolding process and also has the outstanding feature of being able to extend the certification stage by simply adding an insert tag. Up to 10 inserts can be added per tag.

MAXSafe® Scaffold Tags are the best single package solution in almost every situation for ensuring safety for all users of the scaffold. Designed for use on all work sites from mining, maintenance, to small construction sites, always providing the highest level of safety and compliance.

Suitable for all industries including:

- Oil & Gas, Mining
- Offshore, Infrastructure
- Maintenance & Shutdowns
- Events & Arenas
- Construction



THE SIMPLE 3 STEP PROCESS IN 1 TAG

Step 1 - Installation



Fix MAXSafe® Scaffold tag to the most visible place on scaffold and access will be clearly and concisely prohibited while installation is in progress.

Step 2 - Certification



For Certification of Scaffold, simply fold tag to next stage and clip in tabs to show that the scaffold has been certified and can be accessed.

Step 3 - Modification & Dismantling



For dismantling or modification, simply fold tag back to Step 1, which will alert all users that the scaffold may not be accessed. (The tag does not have to be removed to fold back.)

FEATURES

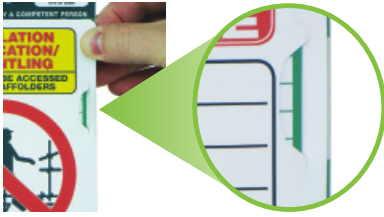

Quick Release Tabs

With our unique 'Quick Release Tab' system, the tag can be easily swapped between phases, and is very effective at holding in place.

Industry Problem Rectified: Means no insert tag is left flapping.

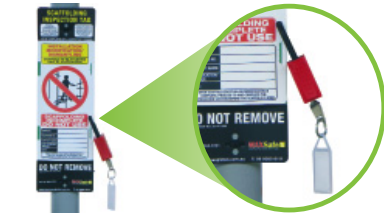

Dedicated Lockout Point

The only Scaffold Inspection Tag in the industry to come with a dedicated, built-in Lockout Point on the 'Do Not Use' stage. Lockout Padlocks or Cable Ties can be used to secure on the 'Do Not Use' stage.

Industry Problem Rectified: Means no one else can swap the tag to Certification when scaffold is not ready.



Check Special Notes 'Tick Box'

With a clearly identifiable box for marking if there are Special Notes, the need for checking before accessing is made clear for all trades.

Industry Problem Rectified: No need to spend time checking all sides of tag for Special Notes if box is not ticked.



Dedicated 'Special Notes' Section

A dedicated 'Special Notes' section is located on reverse side of certification stage of tag. A simple and efficient way to allow all users to check instantly.

Industry Problem Rectified: Plenty of room to write specific and detailed Special Notes.



Certification Extended Section

A dedicated section in centre of tag for Extra Certification tags, has 4 holding tabs to ensure they cannot blow out. Users of the scaffold are notified of this by a tick box on the front tab.

Industry Problem Rectified: Extend tag life on job site indefinitely by using inexpensive Extra Certification tag.



Handover Certificate 'Tick Box'

It can be clearly marked on Certification Tab if handover certificate is in use or not.

Industry Problem Rectified: Eliminates confusion as to whether a handover certificate has been used or not.



Universal Cable Tie Holes

The tag has dedicated cable tie points at top and bottom for quick mounting on scaffold tube. It enables the user to position tag exactly where needed.

Industry Problem Rectified: Does not have to be hung on a horizontal tube like the traditional tags do.

SCAFFOLD TAG KIT

MAXSafe® Scaffold Inspection Tags can be purchased in kit form for start up users, or as individual components according to your requirements.

Includes:

- 20 x MAXSafe® Scaffold Tags - Standard
- 10 x MAXSafe® Scaffold Tags - Extended/Duplicate
- 1 x PK/100 Cable Ties
- 1 x Permanent Marker Pen

PRODUCT CODE: MAX-STKIT



SCAFFOLD INSPECTION TAG COMPONENTS



MARKER PEN

PRODUCT CODE: MAX-STPM

DESCRIPTION: 1 pc Permanent Marker Pen



CABLE TIES

PRODUCT CODE: MAX-STCT

DESCRIPTION: Cable Ties - PK/100

MAXSafe® Scaffold Tag – Standard

| PRODUCT CODE | PACK QTY |
|--------------|----------|
| MAX-ST011 | 20 |
| MAX-ST012 | 100 |
| MAX-ST013 | 500 |

MAXSafe® Scaffold Tag – Extended/ Duplicate

| PRODUCT CODE | PACK QTY |
|--------------|----------|
| MAX-STEX1 | 50 |
| MAX-STEX2 | 500 |
| MAX-STEX3 | 1000 |

We reserve the right to change the product specification without notice.